

DIMENSIONS OF PC BOARD HOLES(COMMEND) BOTTOM VIEW

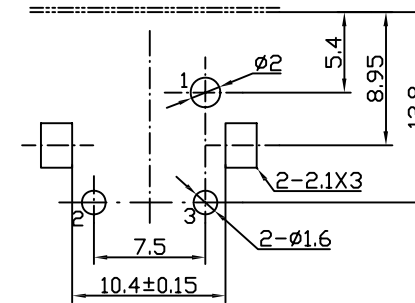

△ COLOR GUIDE:

SERIES No.		010	020	030	040	050	060	070	080	090	100	
COLOR	BL=BLUE	A	R	B	R	W	Y	□	G	R	BL	R
	B=BLACK W=WHITE	B	W	B	B	R	Y	□	□	Y	Y	G
	Y=YELLOW R=RED											
	O=ORANGE G=GREEN											

- △ TECHNICAL REQUIREMENT:
1. THIS PRODUCT MEETS EU RoHS RELATED REQUIREMENT
 2. SURFACE CONDITIONS TO BE WITHIN SPECIFICATIONS
 3. THE ELECTRONIC PERFORMANCE TO BE WITHIN SPECIFICATIONS.

CIRCUIT DIAGRAM

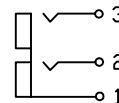

△ 7	SHIELD PATCH, METAL FACE PLATE	1	H62 BRASS t=0.25	CuSn
△ 6	WASHER	2	PBT(PER COLOR GUIDE)	-
5	PINCER NEEDLE(L)	1	H62 BRASS t=0.4	CuSn
4	PINCER NEEDLE(S)	1	H62 BRASS t=0.4	CuSn
△ 3	BASE	1	PBT(BLACK)	-
2	COVER	1	PBT(BLACK)	-
1	OUTER CONDUCTOR	1	H65 BRASS t=0.4	Au
No.	NAME	QTY	MATERIAL	PLATING

NOTE: ALL DIMS ARE IN mm

PROJECTION		Research Develop Innovate RDI, Inc. 333 North Bedford Road, Suite 135, Mount Kisco, NY 10549	
SCALE N/A	TITLE 2X1 RCA JACK W/METAL FACEPLATE-RoHS COMPLIANT		
TOLERANCE EXCEPT AS NOTED	DR. JY	DATE 12/19/08	REF. △ P/N: RH1020-XXX-MFP-G-NL
DEC. MILLIMETERS <6±0.2 6~20±0.3 >20±0.4	CK. GM	PRE- JK	DRAWING NO. SIZE REV. 3553 A A
THIS DOCUMENT IS OWNED BY, AND THE INFORMATION CONTAINED IN IT IS PROPRIETARY TO, RDI, BY RECEIPT HEREOF THE HOLDER AGREES NOT TO USE THE INFORMATION AND NOT TO DISCLOSE IT TO ANY THIRD PARTY, NOR REPRODUCE THIS DOCUMENT WITHOUT THE WRITTEN CONSENT OF RDI, AND AGREES TO RETURN THIS DOCUMENT FORTHWITH UPON REQUEST.			

09-294	10/26/09	A	REVISION AS ABOVE	CP	JY
ECN#	DATE	SYM	REVISION RECORD	AUTH	BY